

VHF HOUSE GRANTS PROGRAM

FASCIA, GUTTERS & DOWNSPOUT REQUIREMENTS

VHF has assembled these requirements for its House Grants Program. It is the homeowner's responsibility to ensure that work is done per the requirements. Failure to comply with these requirements will likely affect payment of the grant in full or part. To ensure full compliance please provide prospective contractors with a copy of the applicable requirements for the project and ask them to specify these requirements in their quotes. The contractor's on-site representative should also be provided with a copy before work commences.

Fascia, Gutters & Downspouts

- Gutter replacement should be coordinated with re-roofing, and both should precede painting.
- Fascia boards and rafter ends should be checked for rot, and repairs included in quotes.
- Do not allow contractors to cut off the exposed or notched rafter ends (typically found on Craftsman style houses, Fig. 1) to allow installation of larger gutters.
- Built-in gutters should be repaired and retained rather than attaching new ones.
- When repairing or replacing deteriorated woodwork, use original wood species (likely fir or cedar) and ensure that the exact profile of the original material is replicated. (Most modern stock lumber has rounded edges and is likely smaller than the original and may not be an acceptable replacement.)
- All new woodwork must be primed with alkyd (oil) primer on all sides at time of installation.
- Original gutter & downspout materials are preferred (i.e. wood, galvanized metal), but pre-finished enameled steel or aluminum is acceptable if compatible with colour scheme of house.
- Original profile of gutters (typically ogee or K-style, Fig. 2) and downspouts should be replicated.
- Downspouts in Victoria were typically round (2" or 3" is available). Square downspouts will not be funded unless there is documentary evidence that they were original to the house



Fig. 1 Notched rafter ends

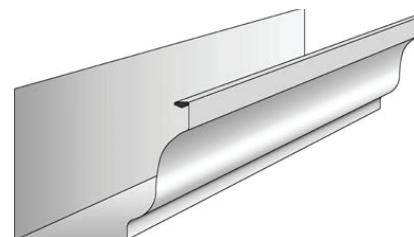

Fig. 2 Ogee or K-style gutters